



TETRA TECH

UNDER ICE BED PHOTO SAMPLING



SUSITNA-WATANA
HYDROELECTRIC PROJECT

Date & Time: 3-26-2014 1130

Crew: MP, BT, RK

Sheet 1 of 2

Location: PRM 21.8

Weather: Partly sunny

Camera: 44 - S26 - 60Pm - 1

GPS Unit: GPX

Comments: 1st CAM #1 #516 Lt side Achan looking Rt 517 Rt side Achan looking Lt, 518 view upstream
SA view upstream

(A) Sample #	(B) GPS Point #	(D) Snow Depth (ft)	(E) Ice Thickness (ft)	(F) Top of Ice to Bed Distance (ft)	(G) Flow Depth (F-E) (ft)	(H) Frazil Ice Present?	(I) Anchor Ice Present?	(J) Freeboard Height (ft)	(K) Camera Height above Bed (ft)	(L) Video #	(M) Comments / Bed Description
S1	1	2.5	2.5	110	7.3	Y	N	0.3	4.3	119, 120, 121	119 @ 4 ft 4 lights 120 @ 3.5, 4 lights 121 @ 3.4 lights Sand in image
S2	2	0.0	2.8	127	7.8	Y	N	0.3	3	122	2 lights, sand
S3	3	0.0	3.1	123	7.2	Y	N	0.4	3	123	2 lights
S4	4	0.0	3.6	135	7.7	Y	N	0.4	3.2	124, 125, 126	124 meters not working 125 red 0.7 lights 126 red 0.4 lights
S5	5	0.0	3.5	145	8.6	Y	N	0.4	4.3	130 @ 4 ft	turbid 130 @ 4 ft 127 red 0 128 red 0 129 @ 2.4 ft
S6	6	0.0	3.6	148	8.7	Y	N	0.3	3	133	turbid
S7	7	0.0	3.6	172	10.7	Y	N	0.3	3	134	turbid
S8	8	0.0	3.7	168	10.3	Y	N	0.4	3.2	135, 136	135 @ 3 ft 5 lights 136 @ 2.6 lights
S9	9	0.0	3.7	164	10.0	Y	N	0.3	2	137	turbid
S10	10	0.0	3.4	160	9.9	Y	N	0.3	2	138	turbid
S11	11	0.0	3.5	170	10.7	Y	N	0.3	2	139	turbid
S12	12	0.0	3.5	167	10.0	Y	N	0.3	2	140	turbid
S13	13	0.0	3.3	150	9.2	Y	N	0.3	2	141	turbid
S14	14	0.0	3.3	150	9.2	Y	N	0.2	2	142	turbid
S15	15	0.0	3.2	150	9.2	Y	N	0.3	2	143	cornets in image
S16	16	0.0	3.2	148	9.2	Y	N	0.4	2	145	gravelts in image
S17	17	0.0	3.5	148	8.5	Y	N	0.3	2	146	gravelts in image

QC1 517/17 0.0 Photo Backup # 397

Photo Backup Kilger Current # 397

Aerial Photos

Kilgus camera
Photos #

- 323
- 324
- 325
- 326
- 327
- 328
- 329
- 330
- 331
- 332
- 333

17 holes spaced @ 15-20'

Flow

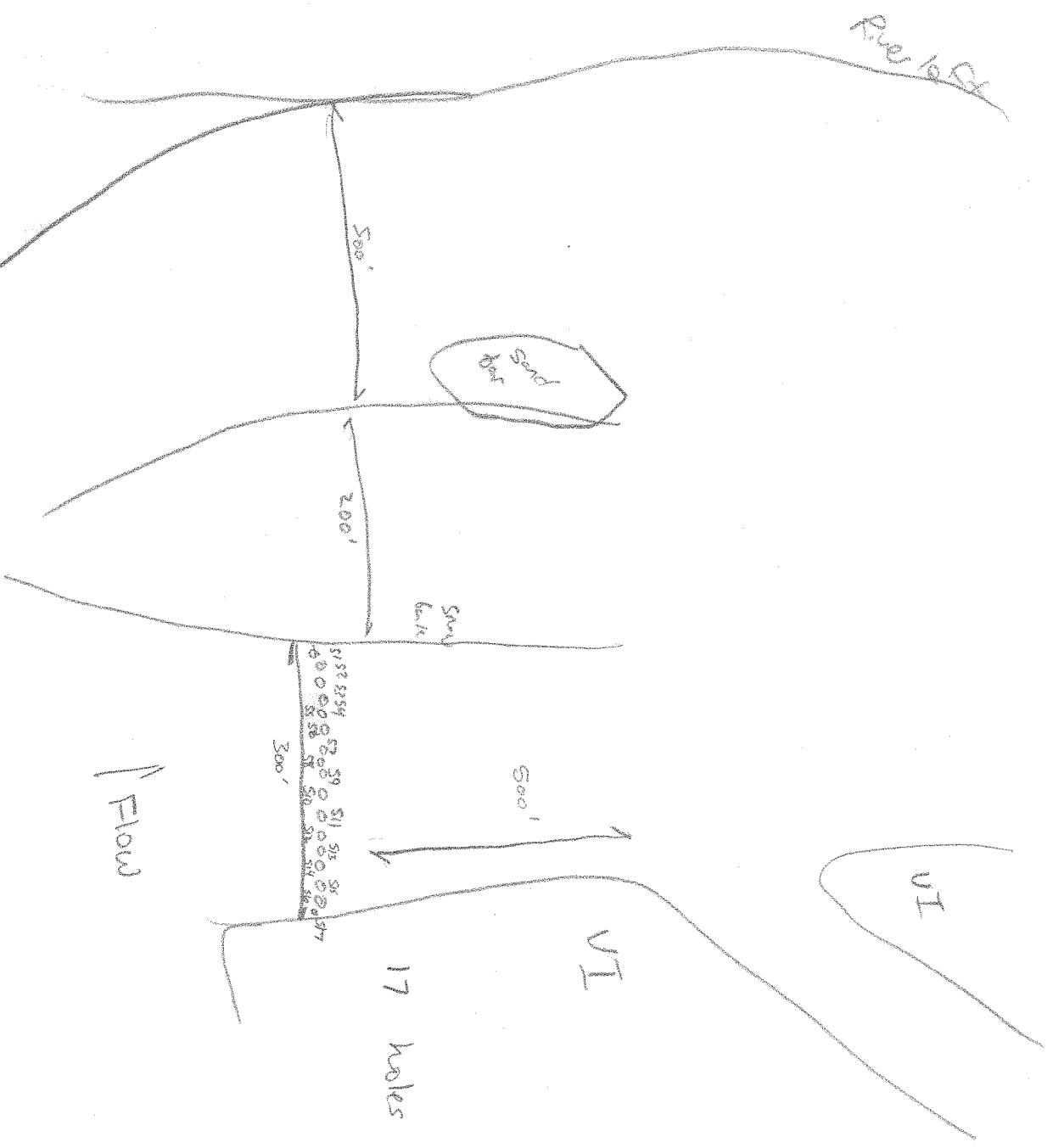

OC RHT

Photo Backup Kilgus camera # 398